

New Longview Building, 31

Application #PL2020-224

October 8, 2020



LEE'S SUMMIT
MISSOURI



Yours Truly



Existing (Good Vets)

- 29,886 sq. ft. 0.69 acres
- 5,390 total bldg. sq. ft.
- 0.18 total FAR

Shared Parking

- 22 stalls
- 8 Street Frontage
- 14 Stalls
- 2 handicapped



Proposed

- 29,886 sq. ft. 0.69 acres
- 0.52 total FAR
- 6,145 sq. ft. bldg. footprint
- 10,235 total bldg. sq. ft.
(1st+2nd floor)

Total Office/Retail Area

(includes existing Good Vets
+Proposed building)

- 15,625 sq. ft.

Pavement/Drive Area

- 13,437 sq. ft.

Shared Parking

- 49 stalls
- 18 Street Frontage
- 31 Stalls
- 2 handicapped

Open/Landscape Area

- 4,914 sq. ft.

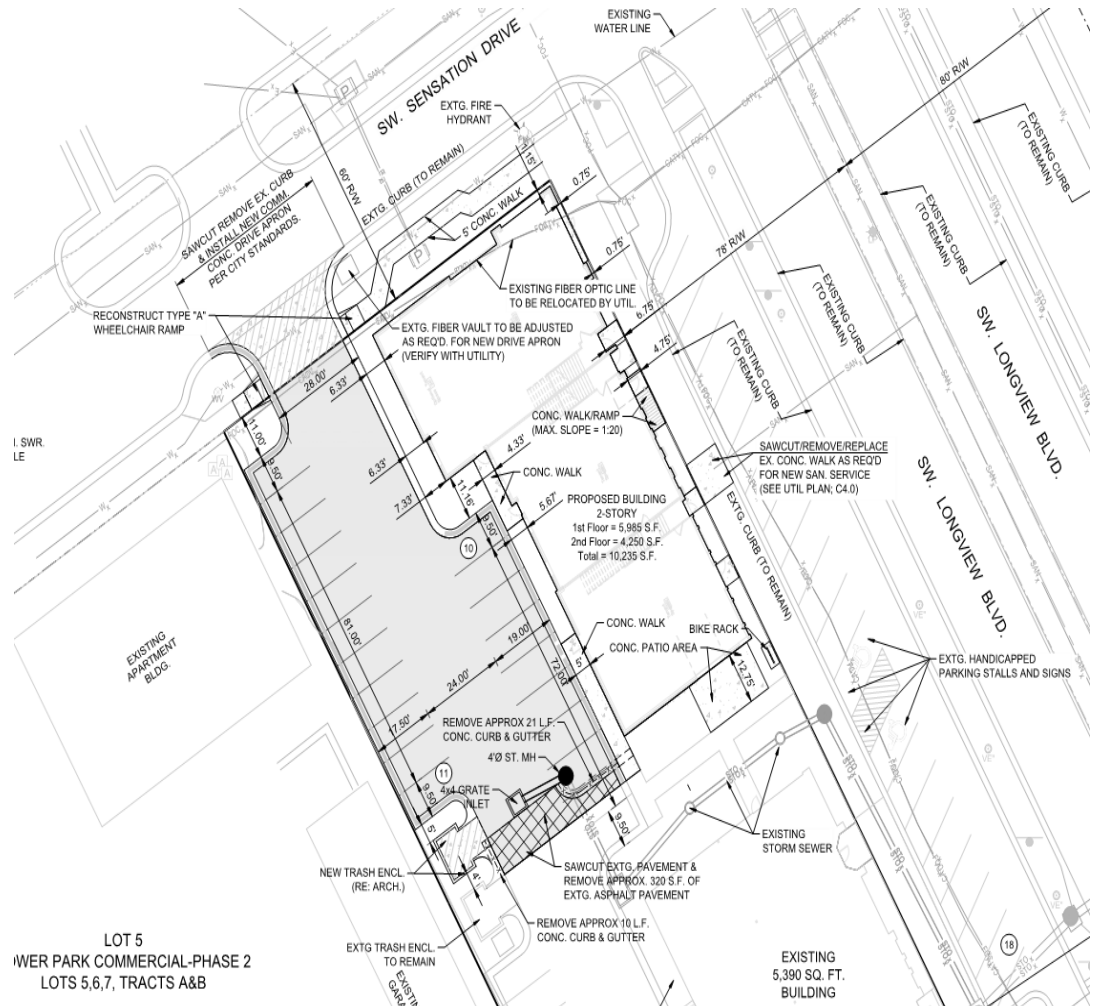

- Painted Synthetic Cladding
- Face Brick
- Cordova Stone
- Fiber Cement Panels
- Fiber Cement Siding



- Development shall be in accordance with the preliminary development plan dated August 25, 2020. The architectural style and building materials for the proposed new building shall be consistent with the building elevations date issued August 6, 2020 and August 26, 2020.
- An Alternate Parking Plan based on the Shared Parking Analysis Study dated September 1, 2020, shall be approved as part of the preliminary development plan for Lot 7 in accordance with Article 8, Division II (Parking) of the UDO.