

RECEIVED

APR. - 4 2016

Planning & Codes Admin



1450 SW Jefferson St. (Summit Christian Elementary School)



1500 SW Jefferson St. (Summit Christian High School)

RECEIVED

APR - 4 2016

Planning & Codes Admin

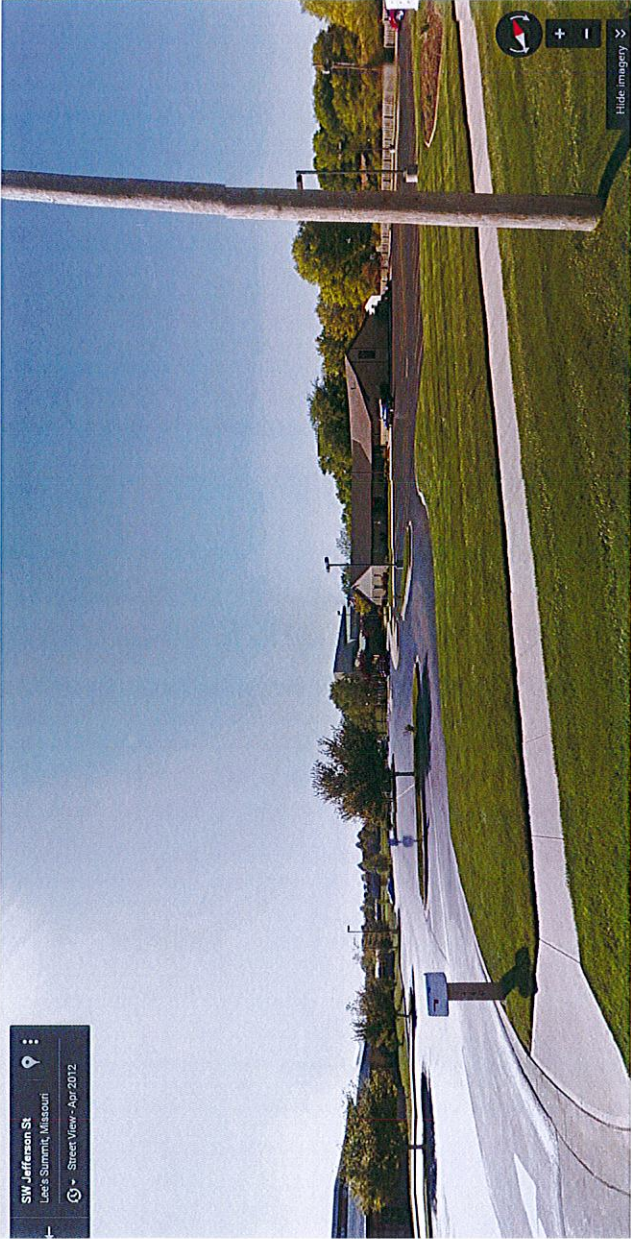

1440 SW Jefferson St. (Lee's Summit Community Christian Church)



1404 SW Market St. (rear of post office east-northeast from property)

RECEIVED

APR - 4 2016

Planning & Codes Admin



1525 SW Jefferson St. (vacant industrially zoned lot, directly east of high school)

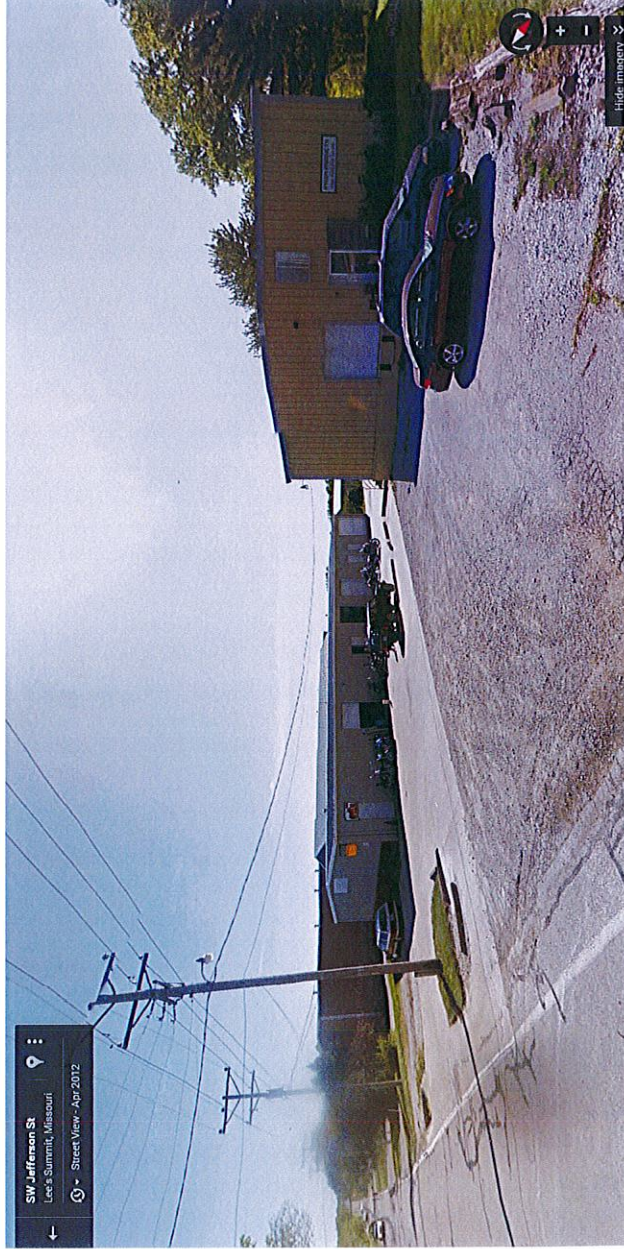

Industrial businesses located to the south on SW Jefferson St.

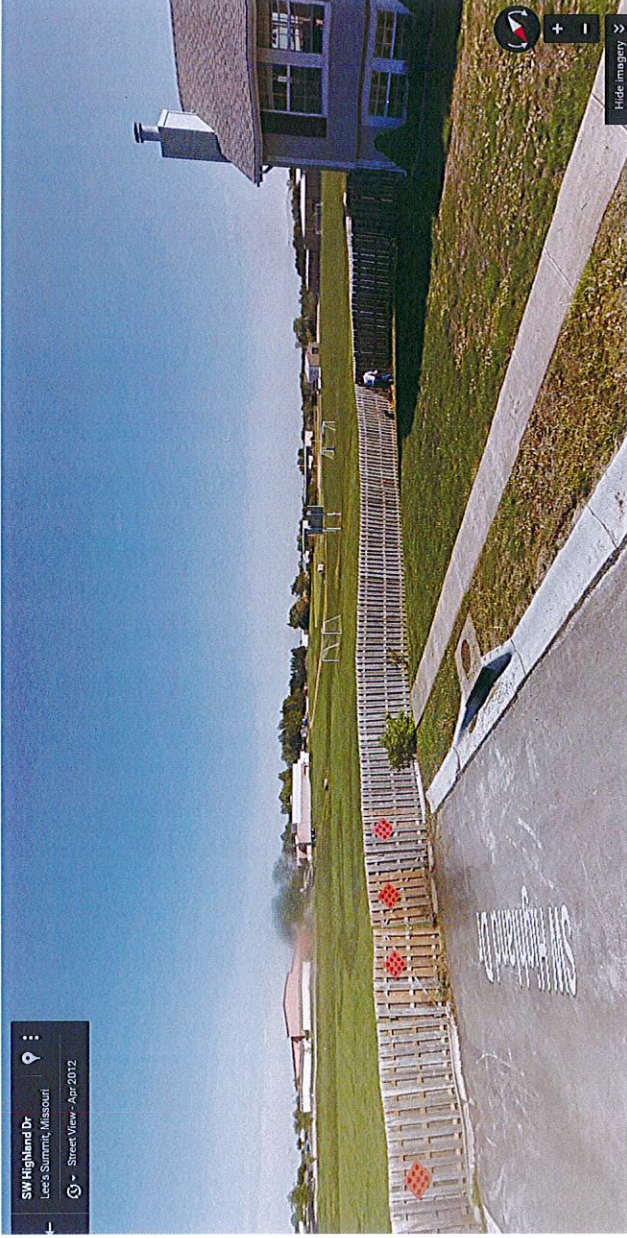

View of school property from end of SW Highland Dr.

RECEIVED

APR - 4 2016

Planning & Codes Admin