

# VILLAGE AT VIEW HIGH - 2ND PLAT

## Preliminary Landscape Plan

Lots 4 thru 45 and Tracts B - E  
Section 3, Township 47 North, Range 32 West  
Lee's Summit, Jackson County, Missouri

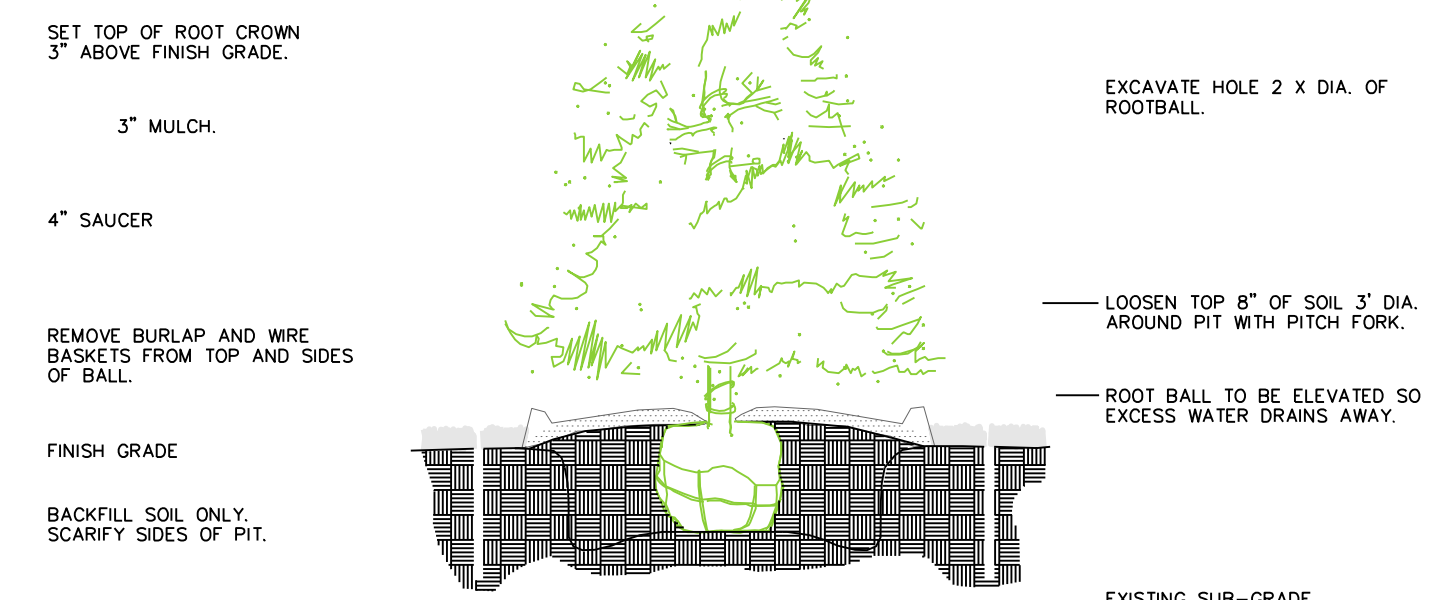
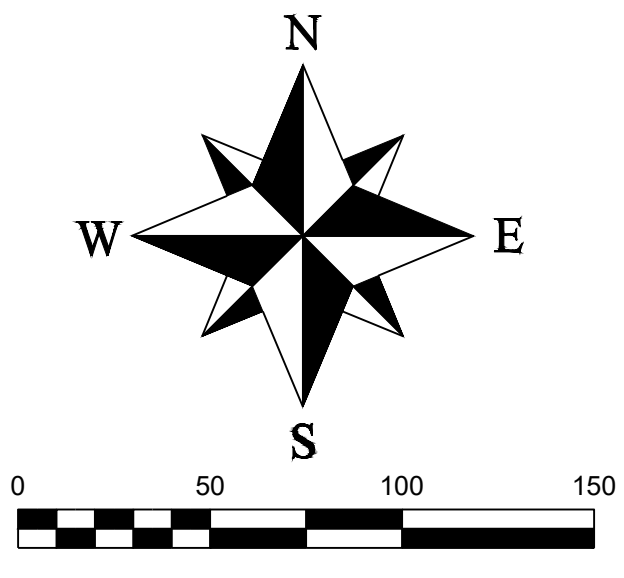

### 1 EVERGREEN TREE PLANTING

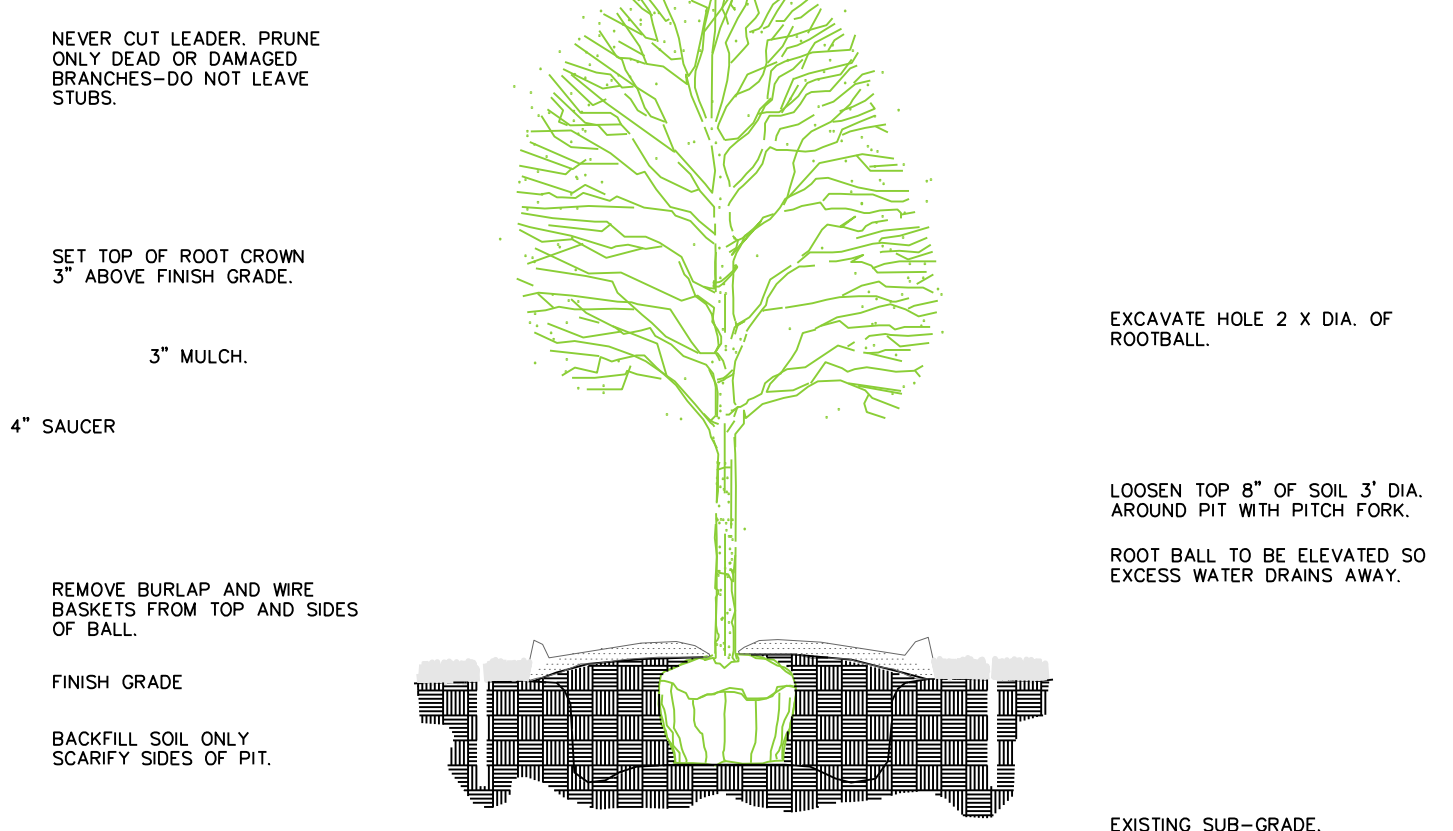

### 2 DECIDUOUS TREE PLANTING

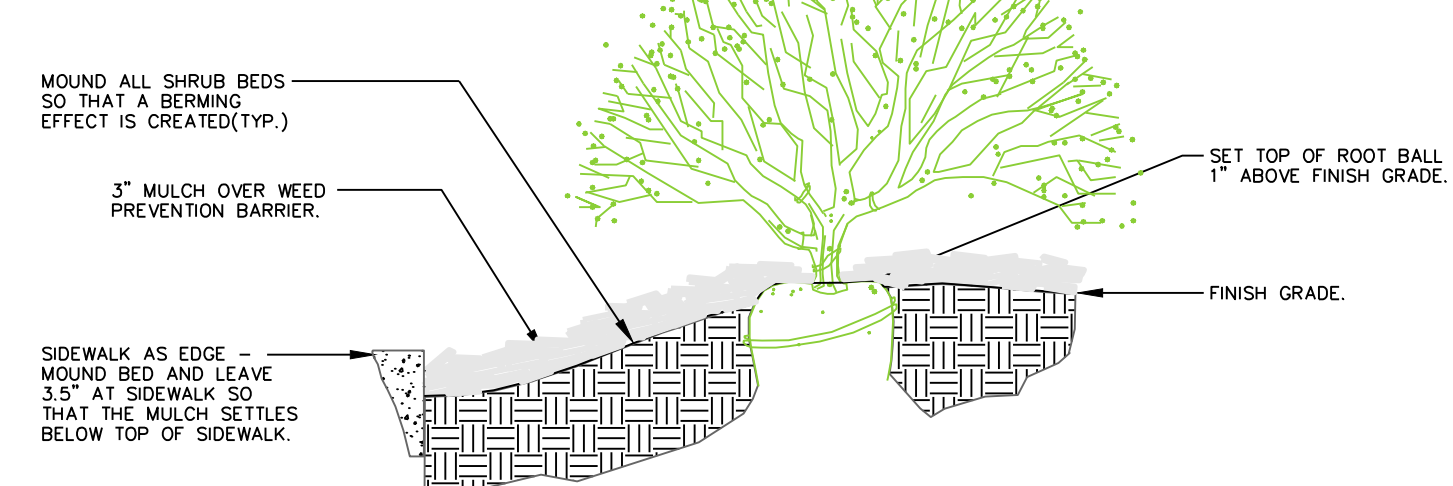

### 3 SIDEWALK EDGE AT PLANT BED

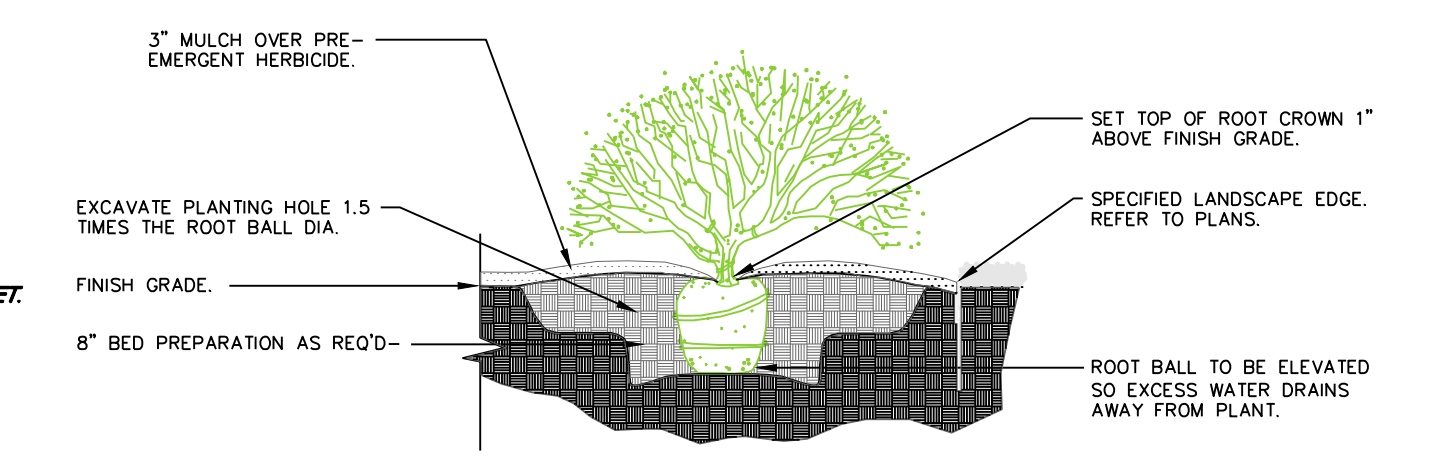

### 4 SHRUB PLANTING

#### PLANTING SCHEDULE:

IS FOR PHASE 1 ONLY. AT FULL BUILD THE UNIFIED DEVELOPMENT ORDINANCE REQUIREMENTS SHALL BE MET.

SYMBOL	QUANT.	KEY	NAME	SIZE
○	28	TA	AMERICAN BASSWOOD LINDEN TILIA AMERICANA	3.0" CAL
●	54	SR	SKYROCKET JUNIPER JUNIPERUS SCOPULORUM "SKYROCKET"	8" HL
○	20	BB	BURNING BUSH BUONYMUS ALATA "COMPACTUS"	#3 POT
●	35	RB	OKLAHOMA REDBUD	3.0" CAL



REVISIONS	
DATE	City Comments
9-6-17	

**LOTS 4 - 45  
and Tracts B - E**  
Section 3, Twp. 47, Rge. 32  
Lee's Summit, Jackson County, Missouri

Preliminary Landscape Plan VILLAGE AT VIEW HIGH 2ND PLAT			
SHEET	SECTION	TOWNSHIP	RANGE
1 OF 1	3	47	32
DRAWN BY		DATE OF PREPARATION	SCALE
M. SCHLICHT		August 4, 2017	1"=80'
PROFESSIONAL SEAL			

**ENGINEERING & SURVEYING SOLUTIONS**  
50 SE 80TH STREET  
LEE'S SUMMIT, MO 64882  
P: (816) 625-9888 F: (816) 625-9849

Future Village at View High