

CATHODIC PROTECTION PROGRAM FY23

WATER UTILITIES DEPARTMENT

CITY OF LEE'S SUMMIT, MISSOURI

2023

PROJECT NO. 97631683

SHEET INDEX:

GENERAL

- 1) COVER SHEET
- 2) GENERAL NOTES, LEGEND & DETAILS
- 3) ABORES
- 4-6) LAKEWOOD OAKS
- 7-11) MEADOWS OF WINTERSET
- 12) PRYOR MEADOWS
- 13) WINDEMERE
- 14-23) RAINTREE LAKE
- 24-26) SURREY TRACE
- 27-30) LONGVIEW FARM
- 31-34) MONARCH VIEW
- 35) TRAFFIC CONTROL

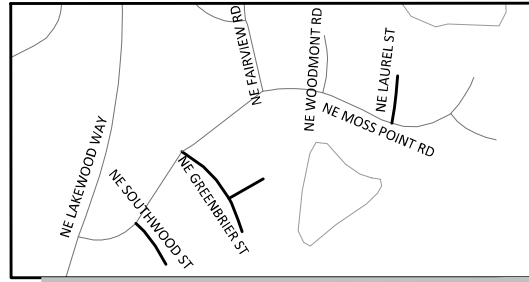

PROJECT LOCATION: ABORES

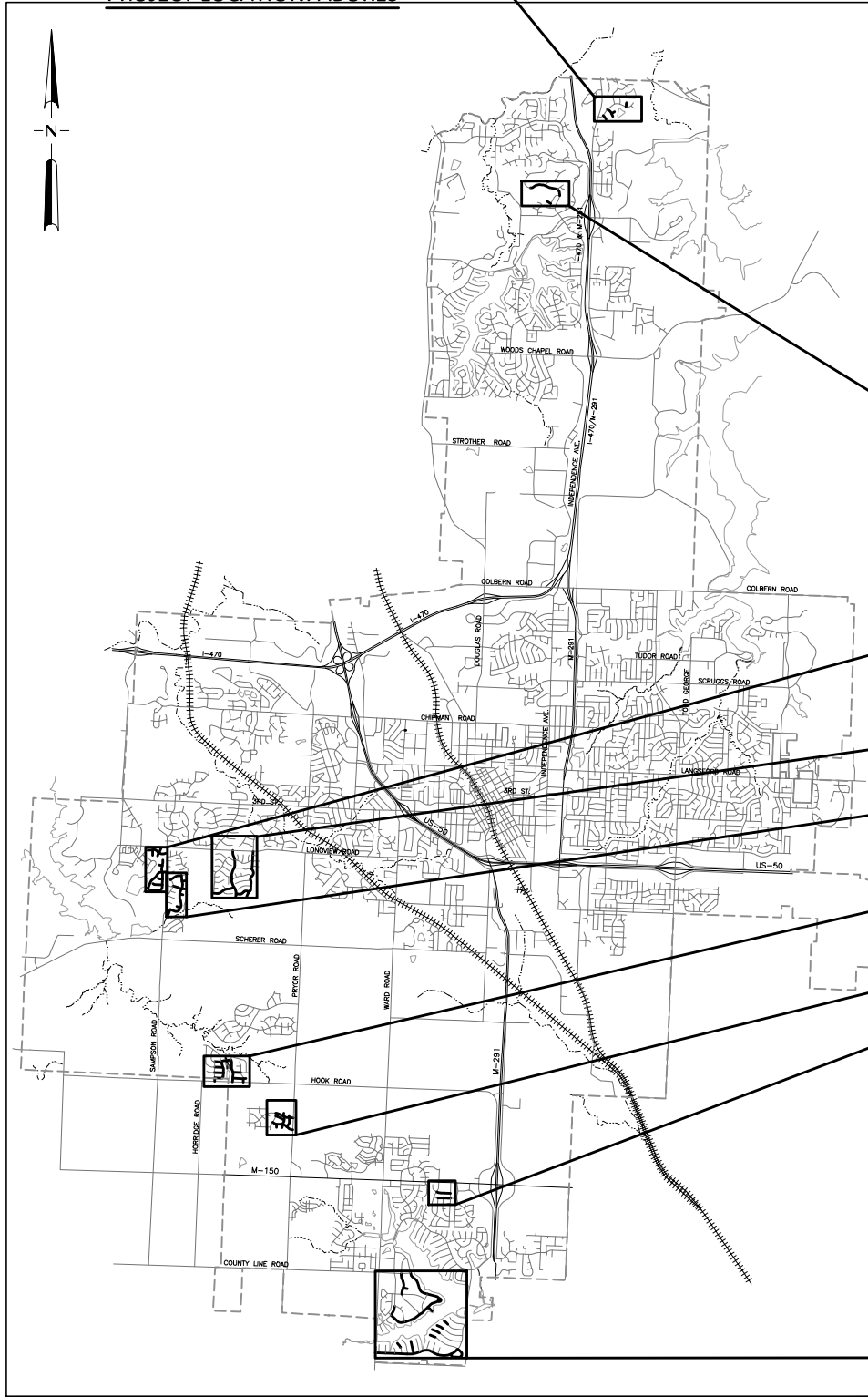

CITY MAP

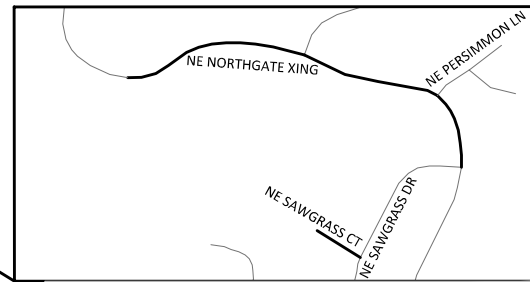

PROJECT LOCATION: LAKEWOOD OAKS



PROJECT LOCATION: LONGVIEW FARM

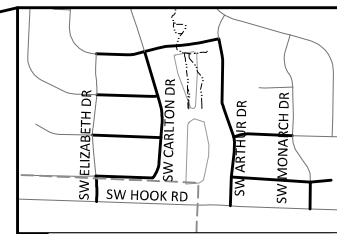

PROJECT LOCATION: MONARCH VIEW

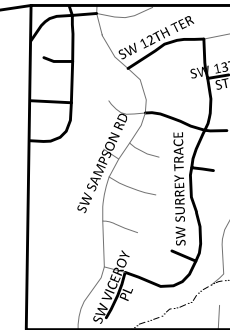

PROJECT LOCATION: SURREY TRACE

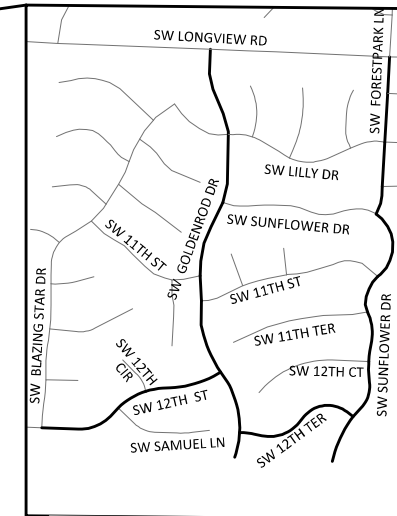

PROJECT LOCATION: MEADOWS OF WINTERSET



PROJECT LOCATION: WINDEMERE

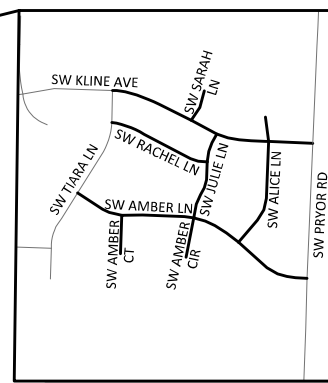

PROJECT LOCATION: PRYOR MEADOWS

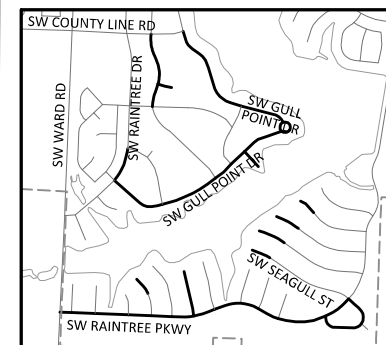

PROJECT LOCATION: RAINTREE SOUTH

UTILITY COMPANIES

BEFORE EXCAVATING CALL: 1 (800) DIG-RITE

GAS	SPIRE ENERGY PEGGY BURNS-YOCUM (816) 969-2218 3025 SE CLOVER DR. LEE'S SUMMIT, MO 64082 peggy.burns-yocum@spireenergy.com	CABLE	COMCAST JIM DUFF (816) 795-2257 3400 NW DUNCAN RD. BLUE SPRINGS, MO 64015 james_duff@cable.comcast.com	WATER & WASTEWATER	LEE'S SUMMIT WATER UTILITIES (816) 969-1940 1200 SE HAMBLEN RD. LEE'S SUMMIT, MO 64081
ELECTRICITY	KCP&L DOUG DAVIN (816) 347-4320 401 SE BAILEY RD. LEE'S SUMMIT, MO 64081 Doug.Davin@kcp.com	GOOGLE FIBER ANDREA SAKLA (415) 736-9962 908 BROADWAY BLVD. KANSAS CITY, MO 64105 kc-google-uc@google.com	STREETS & STORMWATER	PUBLIC WORKS OPERATIONS DIVISION (816) 969-1870 1971 SE HAMBLEN RD. LEE'S SUMMIT, MO 64082	SCHOOLS
TELEPHONE	AT&T CRAIG PERKINS (816) 275-2721 500 East 8th Street, Room 1152 Kansas City, MO 64106 CP0772@att.com	SPECTRUM (816) 508-7287 TROY PREWITT, STEVE BAXTER 8221 WEST 119TH STREET OVERLAND PARK, KS 66213 troy@cablem.com steve.baxter@twcable.com		LS R-7 SCHOOL DISTRICT TRANSPORTATION KEITH HENRY (816) 986-2405	LS R-7 SCHOOL DISTRICT FIBER OPTICS KINZIE WOODERSON (816) 986-1050



NOTE: KNOWN UNDERGROUND UTILITIES IN THE VICINITY OF THE WORK ARE SHOWN ON THESE PLANS, ALTHOUGH OTHERS MAY EXIST. THE LOCATIONS SHOWN ARE BELIEVED TO BE REASONABLY CORRECT, BUT DO NOT PURPORT TO BE ABSOLUTELY SO. BEFORE STARTING WORK, THE CONTRACTOR SHALL GIVE NOTICE TO AND OBTAIN INFORMATION FROM EACH OWNER AND OPERATOR OF EXISTING UNDERGROUND FACILITIES IN ACCORDANCE WITH THE MISSOURI UNDERGROUND FACILITY SAFETY AND DAMAGE PREVENTION STATUTE (RSMO CHAPTER 319.015 - 319.050).



CITY OF LEE'S SUMMIT, MO
WATER UTILITIES DEPARTMENT
ENGINEERING DIVISION
 1200 SE HAMBLEN ROAD
 LEE'S SUMMIT, MO 64081