

Apr. 03, 2018 - 4:50pm - USER: Chris  
 T:\projects\18007\18007\_Courtyards Lee's Summit\Architecture\A1 SITE PLAN.dwg  
 CONFIDENTIAL - PROPRIETARY - THIS DOCUMENT IS THE PROPERTY OF ROSE DESIGN GROUP, INC. AND IS SUBJECT TO RETURN UPON REQUEST. THE DOCUMENT INCLUDES CONFIDENTIAL AND PROPRIETARY INFORMATION OF ROSE DESIGN GROUP, INC. AND IS LOANED IN CONFIDENCE WITH THE UNDERSTANDING THAT IT IS NOT TO BE COPIED OR REPRODUCED WITHOUT THE EXPRESS WRITTEN PERMISSION OF, AND THAT NEITHER THE DOCUMENT NOR THE INFORMATION CONTAINED THEREON WILL BE USED ADVERSELY TO ROSE DESIGN GROUP, INC. ALL PATENT RIGHTS ARE RESERVED.

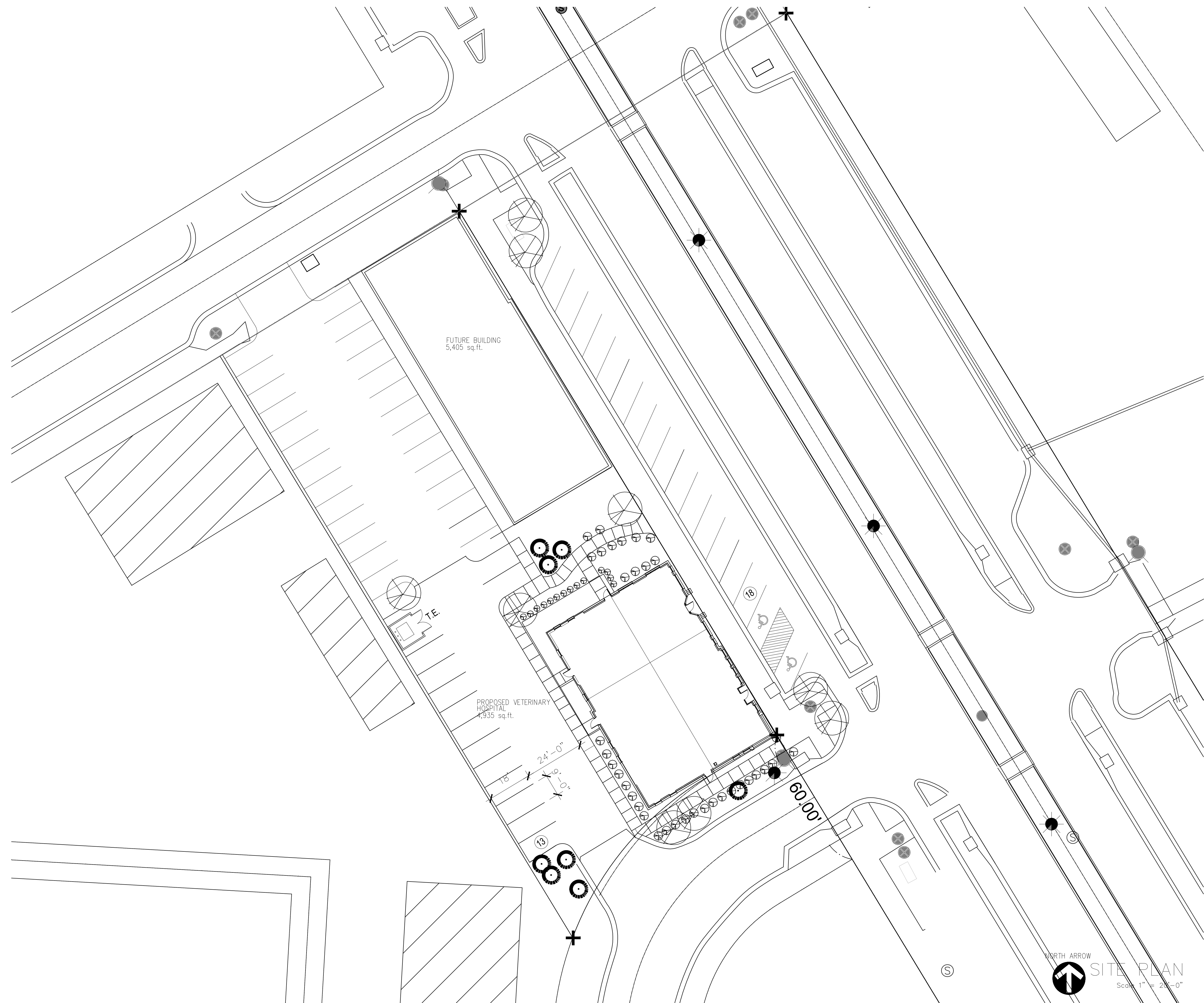

PLAN NOTES

DISCLAIMER  
 I, CHRISTOPHER L. HERRE, AM A REGISTERED ARCHITECT AND A REPRESENTATIVE OF ROSE DESIGN GROUP, INC. I DO HEREBY ACCEPT PROFESSIONAL RESPONSIBILITY AS REQUIRED BY THE PROFESSIONAL REGISTRATION LAWS OF THIS STATE FOR THE ARCHITECTURAL DESIGN DRAWINGS CONSISTING OF ALL SHEETS HEREIN. I SHALL BE RESPONSIBLE FOR ALL OTHER DRAWINGS IN THE CONSTRUCTION DOCUMENT PACKAGE. I AM NOT BEING RESPONSIBLE FOR THE WORK OF OTHER PROFESSIONALS WHOSE SEALS AND SIGNED STATEMENTS MAY APPEAR ELSEWHERE IN THE CONSTRUCTION DOCUMENT PACKAGE.

Christopher L. Herre  
 CHRISTOPHER L. HERRE - ARCHITECT  
 MO# A-5161



ARCHITECTS ■ PLANNERS  
 A Division of Rose Design Build  
 913-782-0777 FAX: 913-782-0998  
 P.O. BOX 100 OLATHE, KS 66051  
 MISSOURI STATE CERTIFICATE OF AUTHORITY # 2006034845 www.BuildWithRose.com

**PROPOSED BUILDING FOR:  
 GOODVETS  
 TOWER PARK DRIVE  
 LEE'S SUMMIT, JACKSON COUNTY, MISSOURI**

NO.	DESCRIPTION	DATE
	SHELL BID SET	

PROJECT NUMBER 18007  
 DATE ISSUED: 03 / 21 / 18  
 SHEET NUMBER

**A1**

SITE PLAN