

RECEIVED  
SEP 06 2016  
Planning & Codes Admin

NSPJ ARCHITECTS  
3515 W. 75TH ST. SUITE 201  
PRIMA VILLAGE, KS 66208  
F: 913.831.1565  
P: 913.831.1415  
ARCHITECTS  
LANDSCAPE ARCHITECTURE  
ENERGY SERVICES  
NSPJ ARCHITECTS  
3515 W. 75TH ST. SUITE 201  
PRIMA VILLAGE, KS 66208  
F: 913.831.1565  
P: 913.831.1415

THE RESIDENCES AT ECHELON  
MO-291 & MO-150  
LEE'S SUMMIT, MISSOURI  
A NEW DEVELOPMENT FOR:

DRAWING RELEASE LOG  
DATE: 09/06/16  
BY: [Signature]

DATE: 09/15/2016  
DRAWN BY: [Signature]  
CHECKED BY: [Signature]  
SCALE: 1"=40'

SHEET NO: L1.00  
NORTH

- LANDSCAPE REQUIREMENTS:
- SECTION 14.00. LANDSCAPING - MINIMUM REQUIREMENTS
1. TREE PER 70 LF OF STREET FRONTAGE.
    - SW CEDARWOOD DR. - 44x16.17.30.14 - 22 TREES
    - SW HOLLYWOOD DR. - 44x16.17.30.14 - 22 TREES
  2. OPEN VARIO USKAS
  3. SW CEDARWOOD DR. - 44x16.17.30.14 - 22 SHRUBS
  4. SW HOLLYWOOD DR. - 44x16.17.30.14 - 22 SHRUBS
- SECTION 14.00. LANDSCAPING - MINIMUM REQUIREMENTS
1. TREE PER 70 LF OF STREET FRONTAGE.
    - SW CEDARWOOD DR. - 44x16.17.30.14 - 22 TREES
    - SW HOLLYWOOD DR. - 44x16.17.30.14 - 22 TREES
  2. OPEN VARIO USKAS
  3. SW CEDARWOOD DR. - 44x16.17.30.14 - 22 SHRUBS
  4. SW HOLLYWOOD DR. - 44x16.17.30.14 - 22 SHRUBS

-2016-149

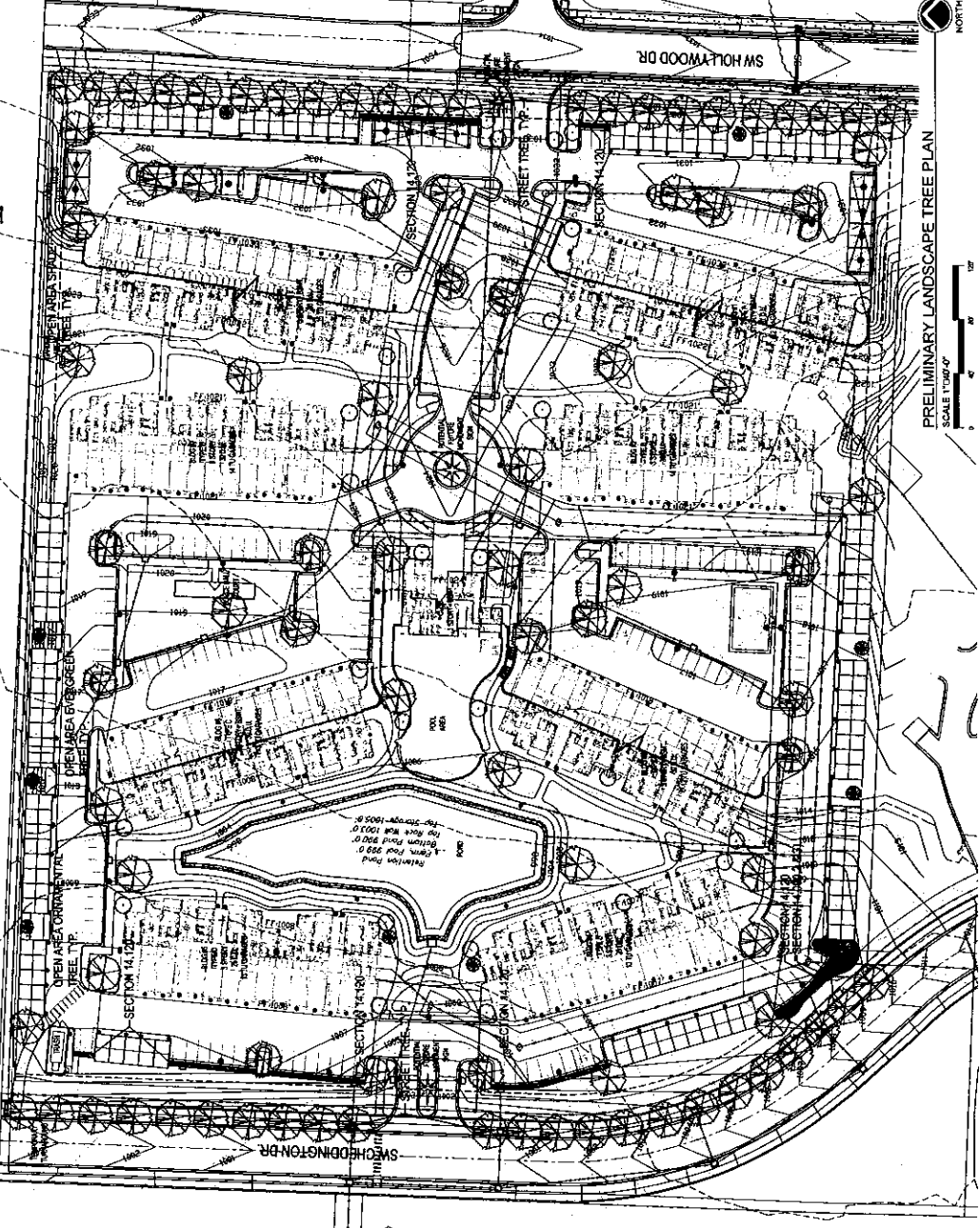

- GENERAL NOTES:
1. EACH DRAWER SHALL VISIT THE SITE OF THE PROPOSED WORK AND EXAMINE THE SITE CONDITIONS. HE SHALL ALSO CAREFULLY EXAMINE THE DRAWINGS FOR THE PROPOSED WORK AND FAMILIARIZE HIMSELF WITH ALL CONDITIONS WHICH MAY AFFECT THE PROPOSED WORK.
  2. THE PLANTING PLAN GRAPHICALLY ILLUSTRATES OVERALL PLANT MASSINGS. EACH PLANT SPECIES MASSING FOR INDIVIDUAL PLANTINGS SHALL BE A MINIMUM OF 2' FROM PAVED EDGE.
  3. A GREENING ROUNDABOUT SHALL BE A MINIMUM OF 2' FROM PAVED EDGE.
  4. ALL PLANTS OF THE SAME SPECIES SHALL BE EQUALLY SPACED APART AND PLACED FOR BEST AESTHETIC VIEWING.
  5. ALL SHRUBS SHALL BE A MINIMUM OF 2' FROM PAVED EDGE.
  6. NOTIFY LANDSCAPE ARCHITECT 1 WEEK PRIOR TO ANY PLANTING OR MATERIAL INSTALLATION LOCATIONS, AND STATE TREE LOCATIONS FOR APPROVAL BY LANDSCAPE ARCHITECT PRIOR TO INSTALLATION.
  7. ALL NEW PLANT BED AREAS TO BE IRRIGATED. REFER TO SPECIFICATIONS FOR IRRIGATION SYSTEM DESCRIPTION.
  8. REFER TO L1.00 SERIES SHEETS FOR TREE PLANTINGS.
  9. REFER TO L1.00 SERIES SHEETS FOR SHRUB PLANTINGS & ROCK MATERIALS.
  10. REFER TO L1.00 SERIES SHEETS FOR PLANTING DETAILS & SPECIFICATIONS.
  11. IN THE EVENT OF WORK IN OR ON THE SANITARY MAIN, ANY TREES OR PLANTINGS PLACED WITHIN THE REMEDIATION AREA SHALL BE REMOVED WITHOUT REPLACEMENT OR COMPENSATION THEREOF AND SHALL BE REPLACED WITHIN THE SAME PERIOD OF TIME AS REQUIRED BY THE CITY.
  12. REFER TO L1.00 FOR ALL PLANTING BEDS AND REPLACE WITH PLANTING SOIL. REFER TO L1.00 FOR PLANTING SOIL MIX.
  13. STEERING STAKES SHALL BE HICKORY GERRY PLASTIC DUE AS PROVIDED BY GEMCO MATERIALS OR APPROVED EQUAL. 24" SO MIN. SIZE. 3" DIA. BY GEMCO DISTRIBUTORS OR APPROVED EQUAL. ALL ROCK BED AREAS SHALL HAVE FILTER FABRIC & BE 4" MIN. DEPTH.

PRELIMINARY PLANT LIST

Common Name	Botanical Name	Size	Notes
Common Tree			
CHM	Chamaecyparis	2' Cal	
COA	Cornus alternifolia	2' Cal	
COB	Cornus florida	2' Cal	
COE	Cornus rugosa	2' Cal	
COF	Cornus flammula	2' Cal	
COG	Cornus canadensis	2' Cal	
COH	Cornus amomum	2' Cal	
COI	Cornus stricta	2' Cal	
COJ	Cornus rugosa	2' Cal	
COK	Cornus rugosa	2' Cal	
COL	Cornus rugosa	2' Cal	
COM	Cornus rugosa	2' Cal	
CON	Cornus rugosa	2' Cal	
COO	Cornus rugosa	2' Cal	
CO1	Cornus rugosa	2' Cal	
CO2	Cornus rugosa	2' Cal	
CO3	Cornus rugosa	2' Cal	
CO4	Cornus rugosa	2' Cal	
CO5	Cornus rugosa	2' Cal	
CO6	Cornus rugosa	2' Cal	
CO7	Cornus rugosa	2' Cal	
CO8	Cornus rugosa	2' Cal	
CO9	Cornus rugosa	2' Cal	
CO0	Cornus rugosa	2' Cal	
CO1	Cornus rugosa	2' Cal	
CO2	Cornus rugosa	2' Cal	
CO3	Cornus rugosa	2' Cal	
CO4	Cornus rugosa	2' Cal	
CO5	Cornus rugosa	2' Cal	
CO6	Cornus rugosa	2' Cal	
CO7	Cornus rugosa	2' Cal	
CO8	Cornus rugosa	2' Cal	
CO9	Cornus rugosa	2' Cal	
CO0	Cornus rugosa	2' Cal	
CO1	Cornus rugosa	2' Cal	
CO2	Cornus rugosa	2' Cal	
CO3	Cornus rugosa	2' Cal	
CO4	Cornus rugosa	2' Cal	
CO5	Cornus rugosa	2' Cal	
CO6	Cornus rugosa	2' Cal	
CO7	Cornus rugosa	2' Cal	
CO8	Cornus rugosa	2' Cal	
CO9	Cornus rugosa	2' Cal	
CO0	Cornus rugosa	2' Cal	
CO1	Cornus rugosa	2' Cal	
CO2	Cornus rugosa	2' Cal	
CO3	Cornus rugosa	2' Cal	
CO4	Cornus rugosa	2' Cal	
CO5	Cornus rugosa	2' Cal	
CO6	Cornus rugosa	2' Cal	
CO7	Cornus rugosa	2' Cal	
CO8	Cornus rugosa	2' Cal	
CO9	Cornus rugosa	2' Cal	
CO0	Cornus rugosa	2' Cal	
CO1	Cornus rugosa	2' Cal	
CO2	Cornus rugosa	2' Cal	
CO3	Cornus rugosa	2' Cal	
CO4	Cornus rugosa	2' Cal	
CO5	Cornus rugosa	2' Cal	
CO6	Cornus rugosa	2' Cal	
CO7	Cornus rugosa	2' Cal	
CO8	Cornus rugosa	2' Cal	
CO9	Cornus rugosa	2' Cal	
CO0	Cornus rugosa	2' Cal	
CO1	Cornus rugosa	2' Cal	
CO2	Cornus rugosa	2' Cal	
CO3	Cornus rugosa	2' Cal	
CO4	Cornus rugosa	2' Cal	
CO5	Cornus rugosa	2' Cal	
CO6	Cornus rugosa	2' Cal	
CO7	Cornus rugosa	2' Cal	
CO8	Cornus rugosa	2' Cal	
CO9	Cornus rugosa	2' Cal	
CO0	Cornus rugosa	2' Cal	
CO1	Cornus rugosa	2' Cal	
CO2	Cornus rugosa	2' Cal	
CO3	Cornus rugosa	2' Cal	
CO4	Cornus rugosa	2' Cal	
CO5	Cornus rugosa	2' Cal	
CO6	Cornus rugosa	2' Cal	
CO7	Cornus rugosa	2' Cal	
CO8	Cornus rugosa	2' Cal	
CO9	Cornus rugosa	2' Cal	
CO0	Cornus rugosa	2' Cal	
CO1	Cornus rugosa	2' Cal	
CO2	Cornus rugosa	2' Cal	
CO3	Cornus rugosa	2' Cal	
CO4	Cornus rugosa	2' Cal	
CO5	Cornus rugosa	2' Cal	
CO6	Cornus rugosa	2' Cal	
CO7	Cornus rugosa	2' Cal	
CO8	Cornus rugosa	2' Cal	
CO9	Cornus rugosa	2' Cal	
CO0	Cornus rugosa	2' Cal	
CO1	Cornus rugosa	2' Cal	
CO2	Cornus rugosa	2' Cal	
CO3	Cornus rugosa	2' Cal	
CO4	Cornus rugosa	2' Cal	
CO5	Cornus rugosa	2' Cal	
CO6	Cornus rugosa	2' Cal	
CO7	Cornus rugosa	2' Cal	
CO8	Cornus rugosa	2' Cal	
CO9	Cornus rugosa	2' Cal	
CO0	Cornus rugosa	2' Cal	
CO1	Cornus rugosa	2' Cal	
CO2	Cornus rugosa	2' Cal	
CO3	Cornus rugosa	2' Cal	
CO4	Cornus rugosa	2' Cal	
CO5	Cornus rugosa	2' Cal	
CO6	Cornus rugosa	2' Cal	
CO7	Cornus rugosa	2' Cal	
CO8	Cornus rugosa	2' Cal	
CO9	Cornus rugosa	2' Cal	
CO0	Cornus rugosa	2' Cal	
CO1	Cornus rugosa	2' Cal	
CO2	Cornus rugosa	2' Cal	
CO3	Cornus rugosa	2' Cal	
CO4	Cornus rugosa	2' Cal	
CO5	Cornus rugosa	2' Cal	
CO6	Cornus rugosa	2' Cal	
CO7	Cornus rugosa	2' Cal	
CO8	Cornus rugosa	2' Cal	
CO9	Cornus rugosa	2' Cal	
CO0	Cornus rugosa	2' Cal	
CO1	Cornus rugosa	2' Cal	
CO2	Cornus rugosa	2' Cal	
CO3	Cornus rugosa	2' Cal	
CO4	Cornus rugosa	2' Cal	
CO5	Cornus rugosa	2' Cal	
CO6	Cornus rugosa	2' Cal	
CO7	Cornus rugosa	2' Cal	
CO8	Cornus rugosa	2' Cal	
CO9	Cornus rugosa	2' Cal	
CO0	Cornus rugosa	2' Cal	
CO1	Cornus rugosa	2' Cal	
CO2	Cornus rugosa	2' Cal	
CO3	Cornus rugosa	2' Cal	
CO4	Cornus rugosa	2' Cal	
CO5	Cornus rugosa	2' Cal	
CO6	Cornus rugosa	2' Cal	
CO7	Cornus rugosa	2' Cal	
CO8	Cornus rugosa	2' Cal	
CO9	Cornus rugosa	2' Cal	
CO0	Cornus rugosa	2' Cal	
CO1	Cornus rugosa	2' Cal	
CO2	Cornus rugosa	2' Cal	
CO3	Cornus rugosa	2' Cal	
CO4	Cornus rugosa	2' Cal	
CO5	Cornus rugosa	2' Cal	
CO6	Cornus rugosa	2' Cal	
CO7	Cornus rugosa	2' Cal	
CO8	Cornus rugosa	2' Cal	
CO9	Cornus rugosa	2' Cal	
CO0	Cornus rugosa	2' Cal	
CO1	Cornus rugosa	2' Cal	
CO2	Cornus rugosa	2' Cal	
CO3	Cornus rugosa	2' Cal	
CO4	Cornus rugosa	2' Cal	
CO5	Cornus rugosa	2' Cal	
CO6	Cornus rugosa	2' Cal	
CO7	Cornus rugosa	2' Cal	
CO8	Cornus rugosa	2' Cal	
CO9	Cornus rugosa	2' Cal	
CO0	Cornus rugosa	2' Cal	
CO1	Cornus rugosa	2' Cal	
CO2	Cornus rugosa	2' Cal	
CO3	Cornus rugosa	2' Cal	
CO4	Cornus rugosa	2' Cal	
CO5	Cornus rugosa	2' Cal	
CO6	Cornus rugosa	2' Cal	
CO7	Cornus rugosa	2' Cal	
CO8	Cornus rugosa	2' Cal	
CO9	Cornus rugosa	2' Cal	
CO0	Cornus rugosa	2' Cal	
CO1	Cornus rugosa	2' Cal	
CO2	Cornus rugosa	2' Cal	
CO3	Cornus rugosa	2' Cal	
CO4	Cornus rugosa	2' Cal	
CO5	Cornus rugosa	2' Cal	
CO6	Cornus rugosa	2' Cal	
CO7	Cornus rugosa	2' Cal	
CO8	Cornus rugosa	2' Cal	
CO9	Cornus rugosa	2' Cal	
CO0	Cornus rugosa	2' Cal	
CO1	Cornus rugosa	2' Cal	
CO2	Cornus rugosa	2' Cal	
CO3	Cornus rugosa	2' Cal	
CO4	Cornus rugosa	2' Cal	
CO5	Cornus rugosa	2' Cal	
CO6	Cornus rugosa	2' Cal	
CO7	Cornus rugosa	2' Cal	
CO8	Cornus rugosa	2' Cal	
CO9	Cornus rugosa	2' Cal	
CO0	Cornus rugosa	2' Cal	
CO1	Cornus rugosa	2' Cal	
CO2	Cornus rugosa	2' Cal	
CO3	Cornus rugosa	2' Cal	
CO4	Cornus rugosa	2' Cal	
CO5	Cornus rugosa	2' Cal	
CO6	Cornus rugosa	2' Cal	
CO7	Cornus rugosa	2' Cal	
CO8	Cornus rugosa	2' Cal	
CO9	Cornus rugosa	2' Cal	
CO0	Cornus rugosa	2' Cal	
CO1	Cornus rugosa	2' Cal	
CO2	Cornus rugosa	2' Cal	
CO3	Cornus rugosa	2' Cal	
CO4	Cornus rugosa	2' Cal	
CO5	Cornus rugosa	2' Cal	
CO6	Cornus rugosa	2' Cal	
CO7	Cornus rugosa	2' Cal	
CO8	Cornus rugosa	2' Cal	
CO9	Cornus rugosa	2' Cal	
CO0	Cornus rugosa	2' Cal	
CO1	Cornus rugosa	2' Cal	
CO2	Cornus rugosa	2' Cal	
CO3	Cornus rugosa	2' Cal	
CO4	Cornus rugosa	2' Cal	
CO5	Cornus rugosa	2' Cal	
CO6	Cornus rugosa	2' Cal	
CO7	Cornus rugosa	2' Cal	
CO8	Cornus rugosa	2' Cal	
CO9	Cornus rugosa	2' Cal	
CO0	Cornus rugosa	2' Cal	
CO1	Cornus rugosa	2' Cal	
CO2	Cornus rugosa	2' Cal	
CO3	Cornus rugosa	2' Cal	
CO4	Cornus rugosa	2' Cal	
CO5	Cornus rugosa	2' Cal	
CO6	Cornus rugosa	2' Cal	
CO7	Cornus rugosa	2' Cal	
CO8	Cornus rugosa	2' Cal	
CO9	Cornus rugosa	2' Cal	
CO0	Cornus rugosa	2' Cal	
CO1	Cornus rugosa	2' Cal	
CO2	Cornus rugosa	2' Cal	
CO3	Cornus rugosa	2' Cal	
CO4	Cornus rugosa	2' Cal	
CO5	Cornus rugosa	2' Cal	
CO6	Cornus rugosa	2' Cal	
CO7	Cornus rugosa	2' Cal	
CO8	Cornus rugosa	2' Cal	
CO9	Cornus rugosa	2' Cal	
CO0	Cornus rugosa	2' Cal	
CO1	Cornus rugosa	2' Cal	
CO2	Cornus rugosa	2' Cal	
CO3	Cornus rugosa	2' Cal	
CO4	Cornus rugosa	2' Cal	
CO5	Cornus rugosa	2' Cal	
CO6	Cornus rugosa	2' Cal	
CO7	Cornus rugosa	2' Cal	
CO8	Cornus rugosa	2' Cal	
CO9	Cornus rugosa	2' Cal	
CO0	Cornus rugosa	2' Cal	
CO1	Cornus rugosa	2' Cal	
CO2	Cornus rugosa	2' Cal	
CO3	Cornus rugosa	2' Cal	
CO4	Cornus rugosa	2' Cal	
CO5	Cornus rugosa	2' Cal	
CO6	Cornus rugosa	2' Cal	
CO7	Cornus rugosa	2' Cal	
CO8	Cornus rugosa	2' Cal	
CO9	Cornus rugosa	2' Cal	
CO0	Cornus rugosa	2' Cal	
CO1	Cornus rugosa	2' Cal	
CO2	Cornus rugosa	2' Cal	
CO3	Cornus rugosa	2' Cal	



