

1 NEW TENANT REVISED FLOOR PLAN  
1/8" = 1'-0"

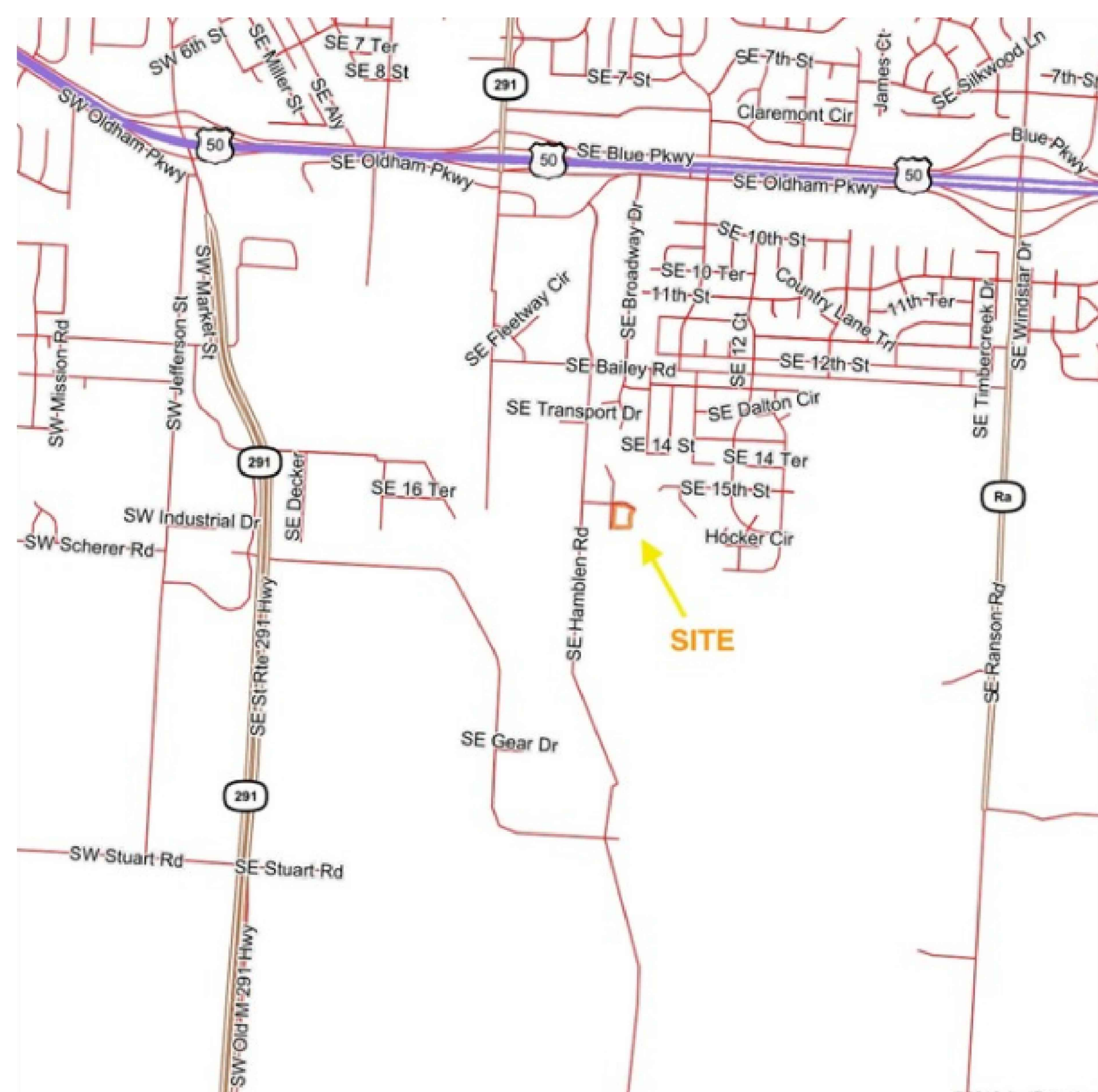

2 LOCATION MAP  
NOT TO SCALE



SEAL:

**THE RESTOMOD STORE  
TENANT FINISH**  
1510 SE KINGSPOINT DR  
LEES SUMMIT, MO 64081

**Hirst and Associates P.C.  
ARCHITECTS & PLANNERS**  
C.M. HIRST  
3810 Beechwood Dr., Lees Summit, MO 64064-1866  
Phone: 816-225-2550  
Email: akhirst@scjglobal.net

**NOTICE:**  
THE PROFESSIONAL SERVICES of the Consultant and/or Architect are undertaken for and are performed in the interest of the Project Owner. No contractual obligation is assumed by the Consultant and/or the Architect for the benefit of any other entity involved in the Project.

**EXISTING CONDITIONS:** The Consultant / Architect disclaims any responsibility for the existing building structure, site conditions, existing construction elements, or any other documents, drawings, or other materials retained to or intended to be used for any part or parts of the project, which do not bear the Architect's seal.

**THIS DRAWING** has been prepared by the Architect, or under its supervision. The drawing is provided as an instrument of service by the Consultant / Architect and is intended for use on the project only. Pursuant to the Professional Home Copyright Protection Act of 1993, all drawings, specifications, ideas and designs, including the overall form, arrangement and composition of spaces and elements, representing the Consultant's original, copyrighted work of the Consultant's practice. Any reproduction, use, or disclosure of information contained herein without the prior written consent of the Architect is strictly prohibited. (C) Copyright 2009 Hirst & Associates

**GENERAL NOTES:**  
Comply with all laws, codes and ordinances of authorities having jurisdiction, and with requirements of the Landlord and / or sub-division restrictions if applicable. Verify actual conditions and dimensions prior to construction. Commencement of work constitutes verification and acceptance of existing conditions. Calculate and measure required dimensions, do not scale the drawings unless otherwise directed. Application of a material or equipment item to work installed by others constitutes acceptance of that work, and assumption of responsibility for satisfactory installation. Dimensions shown are to face of sheathing unless otherwise indicated.

**REVISIONS:**

**PROJECT NO.:**  
**DATE:** 4/29/2019  
**DRAWN BY:** H  
**CADD FILE:** A1  
**CITY APPLICATION #:**

**COPYRIGHT © 2009 HIRST AND ASSOCIATES P.C.**  
**SHEET NO.:** **A1**