

**Construction  
Engineering  
Services, Inc.**

16810 E. 40 Highway  
Independence, Missouri 64055  
Phone (816) 478-2323  
Surveyors Engineers Planners  
Missouri State Certificate of Authority  
2001001857  
Kansas Business Entity  
PE - 834 LS - 136  
krs@engineerinc.com

PROPERTY DESCRIPTION: Lot 13, and the North 1/2 of Lot 14, MUCKEY'S RESURVEY, a subdivision in Lee's Summit, Jackson County, Missouri, according to the recorded plat thereof.  
Parcel No. : 61-510-02-54-00-00-000  
Address of tract: 617 and 621 SE 6th St. Lee's Summit, MO  
Note: No driveways will be permitted access to SE Independence Ave

Prepared For:  
Spellerberg Ent, LLC  
613 NE View Park Dr.  
Lee's Summit, MO 64086

Horizontal Scale 1" = 20'  
Date: 10-27-2020  
1. 12-21-20 surveyed  
2. 12-22-20 address  
3. 3-12-21 13A 60' B/L indep ave.

Detailed: srb  
Muckey's

**SITE PLAN  
617 and 621 SE 6th St.  
Lee's Summit, MO**

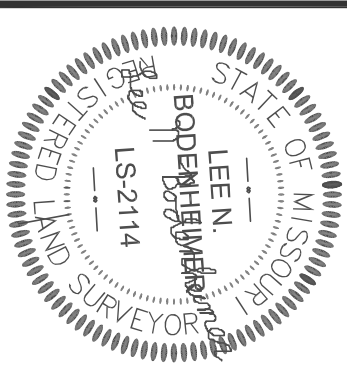

Lee Bodenheimer, MO LS 2114  
Lee Bodenheimer, MO PE 019496  
Lee Bodenheimer, KS LS 838  
Lee Bodenheimer, KS PE 8731

**LEGEND**

- PROPERTY LINE
- BUILD LINE
- CURB
- ROAD CENTERLINE
- SANITARY SEWER
- STORM SEWER
- WATER
- ELECTRICITY
- EXISTING CONTOURS
- PROPOSED CONTOURS

