

RECEIVED

JUN - 2 2016

Planning & Codes Admin

Final Plat of Monticello - 2nd Plat Lots 33 - 69 & Tract D - F Section 4, Township 48N, Range 31W Lee's Summit, Jackson County, Missouri

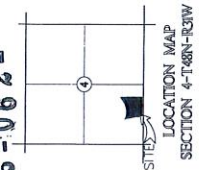

OWNER/DEVELOPER:
Stevenson Development, LLC
Lee's Summit, MO 64069

APPROVED:
PUBLIC WORKS ENGINEERING

PLANNING & CODES ADMINISTRATION

CITY ENGINEER _____ DATE _____

CITY ADMINISTRATION

PLANNING COMMISSION

SECRETARY _____ DATE _____

MAYOR AND CITY COUNCIL CERTIFICATION:
I, _____ Mayor, do hereby certify that the above described plat is in accordance with the provisions of the Missouri Plat Act, Chapter 201, R.S.Mo., and that the same has been reviewed and approved by the City Council on this _____ day of _____, 2016.

NOTARY CERTIFICATION:
I, _____ Notary Public, do hereby certify that I am a duly commissioned Notary Public in the State of Missouri, and that I am duly sworn to perform the duties of my office.

DEVELOPER'S STATEMENT:
I, _____, do hereby certify that I am the owner of the land described herein and that I am duly qualified to execute the same, and that I have the right to dispose of the same as I see fit.

PLANNING & CODES ADMINISTRATION:
I, _____, do hereby certify that the above described plat is in accordance with the provisions of the Missouri Plat Act, Chapter 201, R.S.Mo., and that the same has been reviewed and approved by the City Council on this _____ day of _____, 2016.

PROPERTY DESCRIPTION:
The property described herein is located in Section 4, Township 48 North, Range 31 West, Lee's Summit, Jackson County, Missouri, and is more particularly described as follows: ...

SURVEYOR'S GENERAL NOTES:
1. This survey was made from a true meridian of the State of Missouri, and is in accordance with the provisions of the Missouri Plat Act, Chapter 201, R.S.Mo., and that the same has been reviewed and approved by the City Council on this _____ day of _____, 2016.

REVISIONS	DATE

Lee's Summit, Jackson County, Missouri
Monticello - 2nd Plat

Final Plat of
Monticello - 2nd Plat

PROFESSIONAL SEAL
ENGINEERING - ENGINEERING & SURVEYING
P (616) 471-8883 F (616) 471-7949

