

PRELIMINARY SITE DEVELOPMENT PLAN, DISTRICT C-1

LEGEND:
 PARKING STAGE I RECOMMENDED BY ICDP
 Requires 1075 Spaces for 1075 Beds, 20,000 SF
 Requires 6 Bicycles per 1,000 SF of Bed, 100 per 1000 SF of Living
 Requires 10 per 1000 SF of Bed, 100 per 1000 SF of Living

STAGES:
 STAGE I RECOMMENDED BY ICDP
 STAGE II RECOMMENDED BY ICDP
 STAGE III RECOMMENDED BY ICDP
 STAGE IV RECOMMENDED BY ICDP

NOTE: THESE SITES ARE ONLY IN A CONCEPTUAL, TENTATIVE UNITS SPECIFIC USE AND DENSITIES, COMPLIANT WITH DISTRICT C-1 ZONING ORDINANCE.
 STAGE I RECOMMENDED BY ICDP
 STAGE II RECOMMENDED BY ICDP
 STAGE III RECOMMENDED BY ICDP
 STAGE IV RECOMMENDED BY ICDP

300' PRESENTATION LIMITS
 LIMITS OF REZONING REQUEST
 SECTION LINE & TUGOR ROAD
 RICE ROAD
 U.S. HWY 291
 STAGE I
 STAGE II
 STAGE III
 STAGE IV
 INDICATES STORAGE CONTAINERS

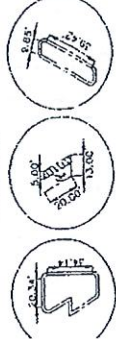
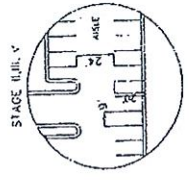
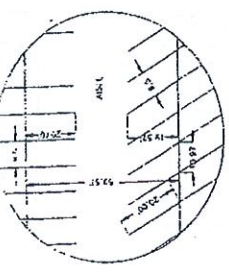
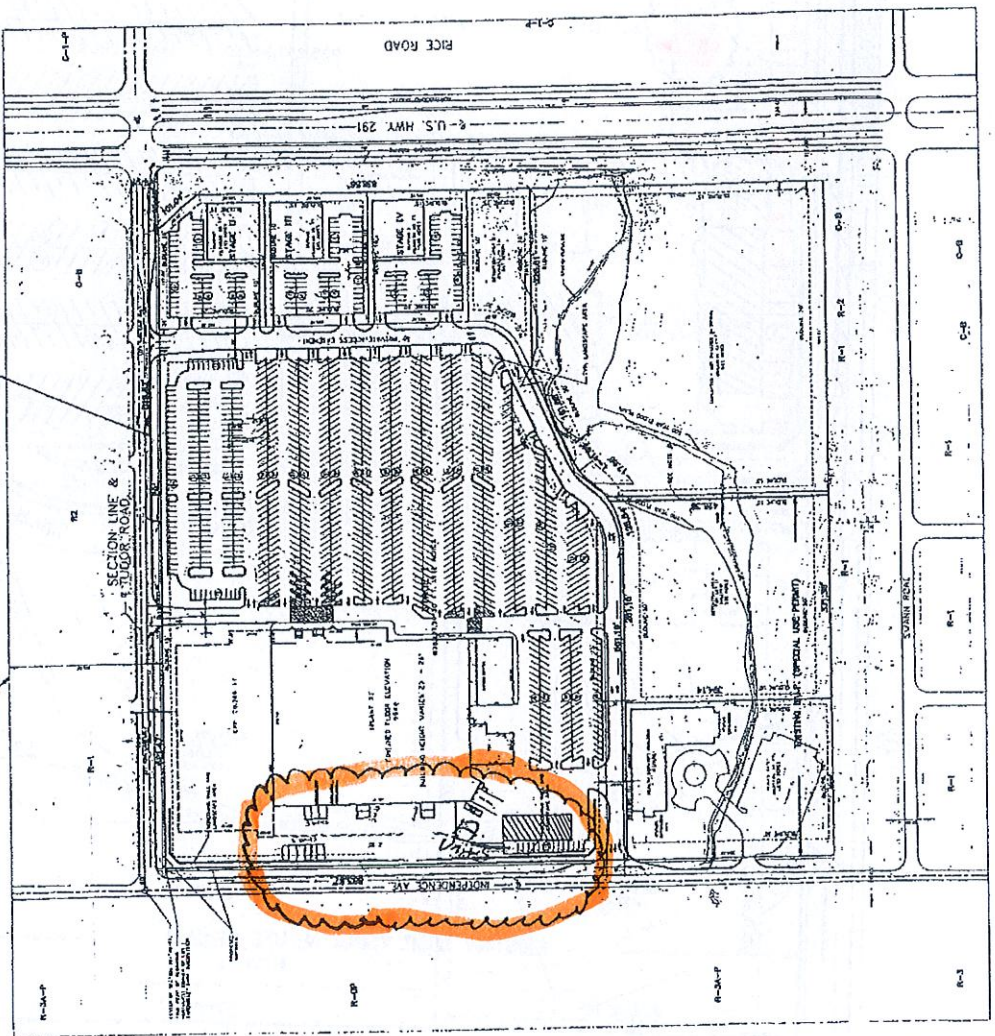

STAGE I
 STAGE II
 STAGE III
 STAGE IV

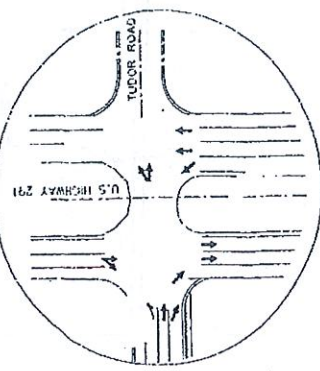

LOT AREA:
 STAGE I
 1075 BEDS, 20,000 SF, 1.25 ACRES
 1075 BEDS, 20,000 SF, 1.25 ACRES
 TOTAL = 2150 BEDS, 40,000 SF, 2.5 ACRES

STAGE II
 250 BEDS, 5000 SF, 0.5 ACRES

STAGE III
 250 BEDS, 5000 SF, 0.5 ACRES

STAGE IV
 250 BEDS, 5000 SF, 0.5 ACRES

TOTAL = 1625 BEDS, 32,500 SF, 1.5 ACRES

NOTE: FOR USE OF REZONING DISTRICT, THE STAGES & THE EAST END OF THE ASSET, 100% ACRES OF THE SOUTHEAST QUARTER OF SECTION 30, TOWNSHIP 36 NORTH, RANGE 10 WEST, IS NOT INTENDED TO BE FINAL PLAN.

OWNER: LEES SUMMIT HOSPITAL FOUNDATION AND RESEARCH MENTAL HEALTH SERVICES WILLIAM C. DIETRICH

DATE: AUG 7 2007

OWNER:
 LEES SUMMIT HOSPITAL FOUNDATION AND
 RESEARCH MENTAL HEALTH SERVICES
 WILLIAM C. DIETRICH

DATE:
 AUG 7 2007

PLANNING AND DEVELOPMENT

LEE'S SUMMIT - PRELIM. SITE DEVELOPMENT

KAW VALLEY ENGINEERING

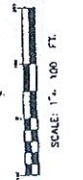

-2007-140-

CENTER OF GRAVITY
TRUE POINT OF BEGINNING
NORTHWEST CORNER OF LOT 1
CARONDELET PARK SUBDIVISION

PROPOSED
SIDEWALK

SCREENING WALL AND
LANDSCAPE AREA

EXP. 22,280 SF

R-OP

121,267 SF
FINISHED FLOOR ELEVATION
994.0

BUILDING HEIGHT VARIES 23' - 26'

835,297.34 SQ. FT. 19.12 ACRES

INDEPENDENCE AVE.

SCREENING WALL AND
LANDSCAPE AREA

R-3A-P

HEALTH SERVICES BUILDING
(FUTURE)

DETENTION AREA A
ON LOT 11
146,178.01
3.25 ACRES

ROADS SITE
116,377.06 SQ. FT.
2.53 ACRES

EXISTING S.U.P. (SPECIAL USE PERMIT)

R-1

SWANN ROAD

R-3

R-1

R-1

R-

