

Bette Wordelman

From: Bette Wordelman
Sent: Wednesday, November 21, 2018 4:37 PM
To: Teresa Treece
Cc: Fred Pickard; Ken Davis; James Pryde; DeeDee Tschirhart
Subject: tow committee compliance report
Attachments: Compliance info for Ron's tow lot.pdf

DeeDee Tschirhart, Acting Procurement Manager, and I visited the site of Ron's Tow lot at 33811 E US Hwy 50 at approximately 1:30 p.m. today. We measured the area of the asphalt lot and made observations of the required signage, software, and other requirements.

Attached is the compliance checklist for the Tow Contract as it relates to Ron's Tow lot. The two primary concerns discussed at the Public Safety Advisory Board meeting on November 20 were about the hard surface of the lot and the capacity to hold approximately 80 vehicles. As you can see on the attached diagram, the asphalt portion of the lot is 18,425 square feet. With the average sedan having a footprint of around 60 square feet, there appears to be more than adequate space for the placement of 80 vehicles on the asphalt surface. While it is true that the entire fenced lot area is not asphalt, the surface area that is asphalt provides adequate space for compliance with the specifications.

The attached Mapquest page also demonstrates that the lot is approximately 11.38 total miles from Lee's Summit City Hall, well within the 20 mile requirement.

Please notify DeeDee or myself if you need any further information to satisfy the needs of the Tow Committee or the Public Safety Advisory Board. Unless we hear something to the contrary by November 30, we will proceed with the recommendation of the PSAB to the Finance and Budget Committee and City Council to award the contract for Bid 2019-016 Tow Services to Ron's Tow for one year with four additional one-year renewal periods beginning February 1, 2019. Thanks for your assistance and support.

Compliance with Bid Section 4.16 Tow Lot

Ron's Auto & Truck Towing
 Physical Address:
 33811 E. US Hwy 50
 Lees Summit, MO 64086

	In Compliance:	
4.16.1	The Tow Lot shall be a sole-use facility (used only for towing).	Y
4.16.2	The Tow Company shall currently own or lease and maintain a Tow storage lot in compliance with requirements stipulated in paragraph 4.16 above.	Y
4.16.3	Storage. Outside storage of automobiles (2-door, 4-door, station wagons and convertibles, American and Foreign made), boats and motors, motorcycles, motor scooters, car trailers, sport utility vehicles, and pick-up trucks up to and including ¾ ton. A separate storage charge per day for a vehicle and trailer towed together will apply. The separate storage charge for the trailer shall be clearly identified on the same tow ticket as the vehicle (One full calendar day or any part thereof). Storage rates may be different for vehicles up to ¾ ton and those over ¾ ton. The City will not be responsible for storage fees on any impounded vehicle on which the Police Department has placed a hold. However, this does not preclude the Towing Company from charging the owner of the vehicle the standard rates established by this contract. The City will not pay storage fees on any City owned vehicle.	Y
4.16.4	The Tow Lot shall be clearly marked and identified by approved exterior signage as the location of the Tow Lot.	Y
4.16.5	The minimum lot size of the Tow Lot shall be able to hold approximately eighty (80) vehicles).	Y
4.16.6	The Tow Lot shall be hard-surfaced (asphalt or concrete).	Y
4.16.7	Vehicles stored in the Tow Lot shall be arranged in rows and not stacked upon one another.	Y
4.16.8	The Tow Lot shall not be located in a 100 year flood plain.	Y
4.16.9	The Towing Company's office shall be open from at least 8:00 a.m. to 6:00 p.m., Monday through Friday.	Y
4.16.10	The Towing Company's office shall have secure, on-site storage for tow records.	Y
4.16.11	The Towing Company's office shall have 24-hour dispatch service and software, and GPS tracking of tow vehicles.	Y
4.16.12	Towing Company shall have personnel on the Tow Lot available to provide the release of vehicles and/or personal property contained in vehicles and to accompany the owner/driver and/or insurance adjusters to vehicles during the hours specified in this contract.	Y
4.16.13	Except as provided in § 304.155, RSMo, the Towing Company shall release personal property from a towed vehicle to the owner of the towed vehicle during normal business hours at the owner's request and at no additional charge. For the purposes of this Contract, personal property shall be defined as items necessary to meet personal needs, but shall not include other personal property such as equipment or tools. When personal property release is in question, the Towing Company shall contact the Police Department for instruction prior to releasing personal property.	Y
4.16.14	Towing Company shall also post at the office of the Tow Lot and at the Police Department a telephone number for the public where Towing Company can be reached on weekends and holidays, between the hours of 8:00 a.m. and 6:00 p.m. Any release of vehicles or personal property outside of normal business hours (8:00 a.m. to 6:00 p.m. Monday through Friday) may incur additional charges. The posting at the Towing Company's office shall be in such a location that it can be read by the public when the Towing Company's office is either open or closed.	Y
4.16.15	Towing Company agrees to provide access to the Tow Lot by City employees on a twenty-four (24) hour basis, seven (7) days per week without charge to the City.	Y

220 SE Green St, Lees Summit, MO 64063 to 33811 E US Highway 50, Lees Summit, MO 64086-9175 D...

YOUR TRIP TO:

33811 E US Highway 50, Lees Summit, MO 64086-9175

13 MIN | 11.4 MI 







Est. fuel cost: \$1.02

Trip time based on traffic conditions as of 10:36 AM on November 21, 2018. Current Traffic: Light



Print a full health report of your car with HUM vehicle diagnostics (800) 906-2502



-  1. Start out going southeast on SE Green St toward SE 3rd St.
Then 0.05 miles.....0.05 total miles
-  2. Take the 1st left onto SE 3rd St.
If you are on SE Green St and reach SE Johnson St you've gone a little too far.
Then 0.67 miles.....0.72 total miles
-  3. Turn right onto SE State Route 294/MO-291. Continue to follow MO-291.
MO-291 is 0.1 miles past SE Independence Ave.
Then 0.88 miles.....1.59 total miles
-  4. Merge onto US-50 E via the ramp on the left toward Sedalia.
If you reach SE Oldham Pkwy you've gone a little too far.
Then 9.67 miles.....11.26 total miles
-  5. Turn right onto S Hutt Rd.
S Hutt Rd is 0.8 miles past Lakota Ln.
Then 0.01 miles.....11.27 total miles
-  6. Take the 1st right onto E US Highway 50.
If you reach E Orter Belt Rd you've gone about 0.5 miles too far.
Then 0.14 miles.....11.38 total miles
-  7. 33811 E US Highway 50, Lees Summit, MO 64086-9175, 33811 E US HIGHWAY 50 is on the left.
If you reach the end of E US Highway 50 you've gone about 0.1 miles too far.

Use of directions and maps is subject to our Terms of Use. We don't guarantee accuracy, route conditions or usability. You assume all risk of use.

135' N to S

151' E to W

Ron's Tow

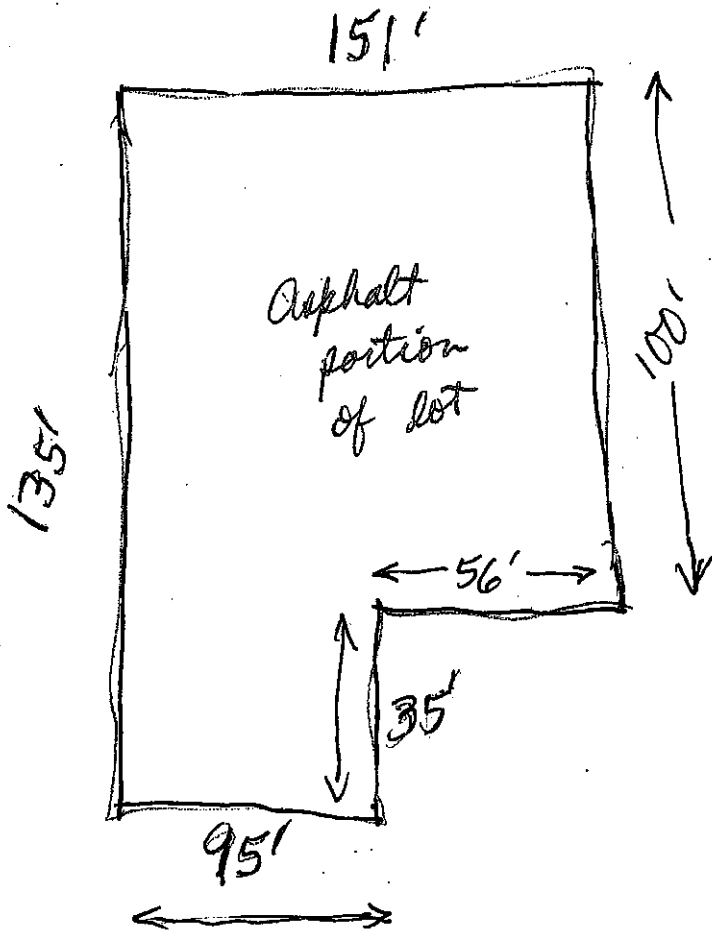

18,425 sq ft